

COMPONENTS

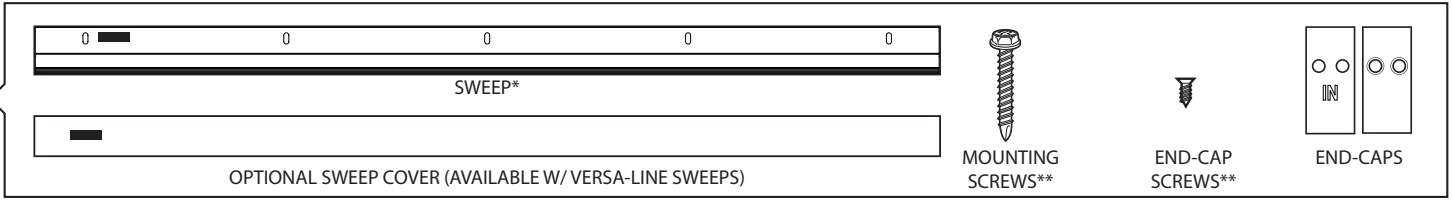

* Sweep shown for reference. Sweep style varies depending on product. ** Extra screws included.

CAUTION!



TOOLS

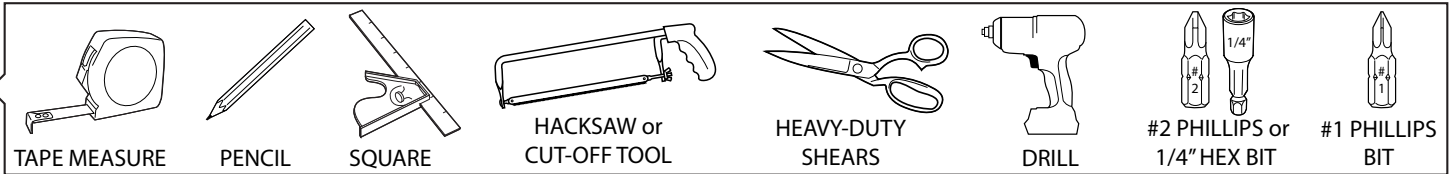

1. MEASURE DISTANCE BETWEEN JAMBS FOR "OUT-SWINGING" DOORS (S1). MEASURE THE DISTANCE BETWEEN DOOR STOPS FOR "IN-SWINGING" DOORS (S2). SWEEP IS INTENDED TO MOUNT ON EXTERIOR OF BUILDING. **SUBTRACT 1/8" FOR "IN-SWING" DOORS TO ACCOUNT FOR END-CAPS.**

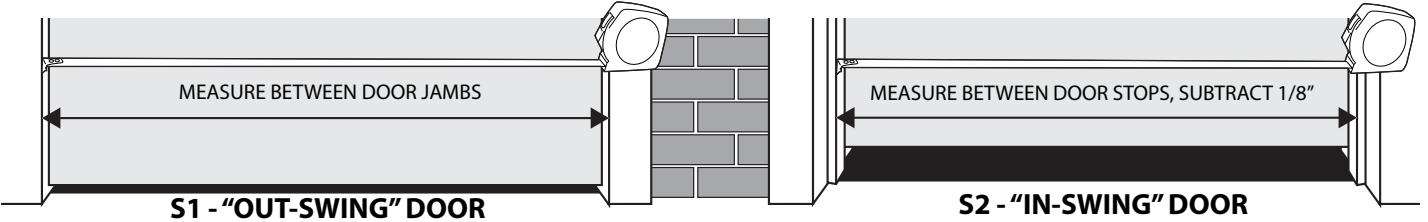

2. MARK THIS DIMENSION ON YOUR SWEEP AND COVER, IF APPLICABLE(S3). USE WOODWORKING SQUARE, OR SIMILAR TOOL TO DRAW LINE (S4).

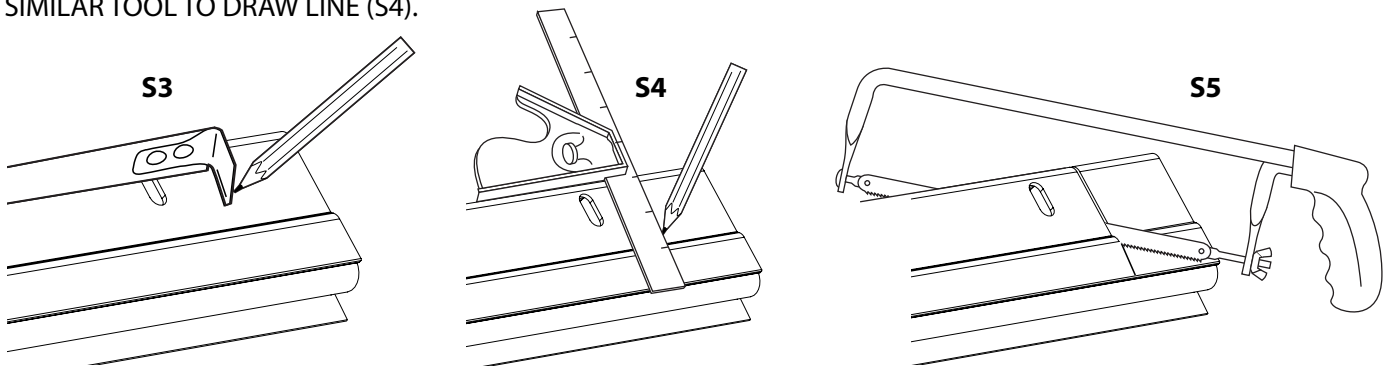

3. CAREFULLY CUT ALUMINUM RETAINER USING HACK SAW OR CUT-OFF WHEEL (S5). STOP CUTTING AFTER RETAINER SEPARATES. CUT STRAIGHT TO ENSURE END-CAPS SIT FLUSH. **NOTE: WHEN CUTTING ALUMINUM RETAINER IT IS OKAY TO CUT THE TOP OF THE SEAL SLIGHTLY.**

4. CUT SEAL COMPLETELY USING HEAVY DUTY SHEARS (S6). CUTTING THIS STRAIGHT AND AS CLOSE TO RETAINER AS POSSIBLE WILL ALLOW END-CAPS TO SIT FLUSH. HOLD THE RUBBER TIGHTLY WHILE CUTTING TO PREVENT RUBBER FROM SHEARING, RESULTING IN ANGLED CUT. IF YOU CAN, MARK RETAINER EDGE LOCATION ON RUBBER, THEN SLIGHTLY PULL RUBBER OUT OF SWEEP & CUT AT MARK. SLIDE BACK INTO PLACE. CLEAN UP ALUMINUM EDGE WITH DE-BURRING TOOL, BLADE, AND/OR METAL FILE, IF NEEDED.

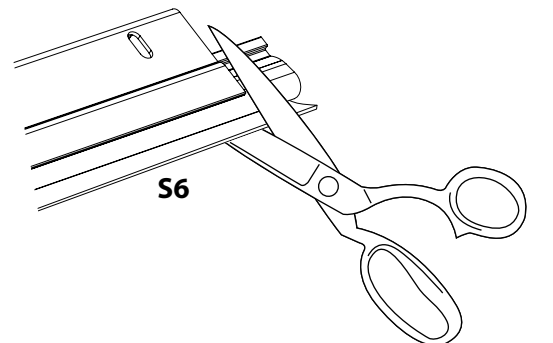

5. WITH "IN" SIDE FLUSH TO RETAINER, ATTACH END-CAPS USING INCLUDED ¼" SCREWS AND A #1 PHILLIPS BIT (S7). TO PREVENT STRIPPING GO SLOW! **TIP: IF YOU ARE DOING MANY DOORS, OR ARE HAVING DIFFICULTY USING THE SMALL SCREWS, OR AESTHETICS ARE NOT PARAMOUNT, YOU CAN ATTACH END-CAPS BY HAMMERING STANDARD NAILS, SUCH AS 1 1/4" (3d) 15 GAUGE TRIM NAILS, INTO THE SCREW SLOTS.**

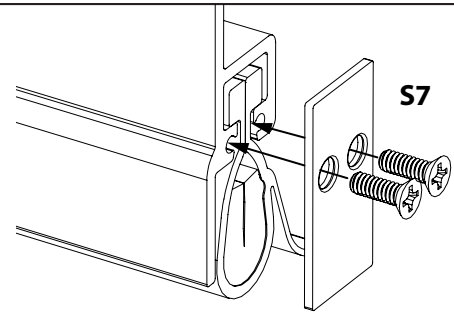

6. PLACE (2) 1/16" SHIMS OR (2) COINS (EX. PENNY, NICKEL, QUARTER) UNDER SWEEP, 2-3" IN FROM EDGES (S8). THIS WILL SET IDEAL GAP UNDER THE XCLUDER FILLED GASKETS.

7. SUPPORT SWEEP ON TOP OF SHIMS, CENTER ON DOOR & AFFIX USING INCLUDED 1" SCREWS & EITHER #2 PHILLIPS OR ¼" HEX BIT. PLACING SCREWS NEAR TOPS OF SLOTS WILL ALLOW FOR MAXIMUM ADJUSTABILITY. **TIP: ONLY FULLY TIGHTEN 2 OUTERMOST SCREWS (S9) AT THIS POINT.**

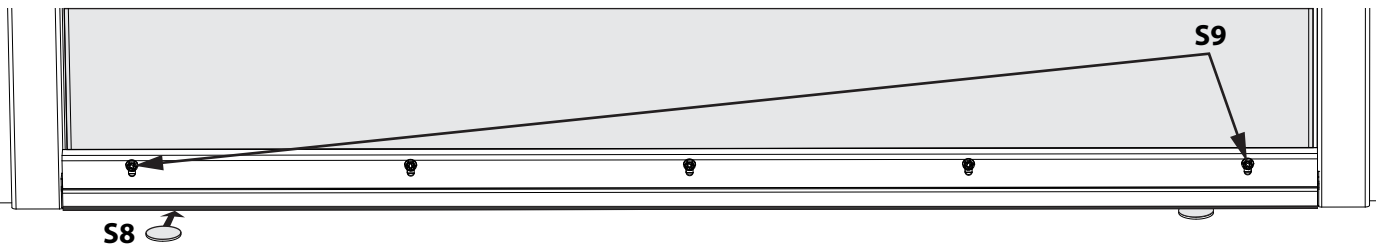

8. REMOVE SHIMS AND CHECK DOOR SWING BY OPENING AND CLOSING THE DOOR SEVERAL TIMES, TAKE NOTE OF ANY EXCESSIVE DRAGGING OR WEDGING. IF NEEDED, LOOSEN SCREW ON PROBLEMATIC SIDE ONLY, SLIGHTLY LIFT SWEEP, AND RETIGHTEN. REPEAT UNTIL DOOR SWINGS UNIMPEDED. **NOTE: FOR MAXIMUM EFFECTIVENESS AGAINST PESTS & THE ELEMENTS THE GAP UNDER GASKET SHOULD BE AS NARROW AS POSSIBLE.**

9. COMPLETE SWEEP INSTALLATION BY TIGHTENING REMAINING SCREWS.

INSTALLATION OF OPTIONAL SWEEP COVER (AVAILABLE W/ VERSA-LINE SWEEPS)

10. USING LINE FROM STEP 2, CUT COVER WITH HACKSAW, CUT-OFF WHEEL, OR MITER SAW WITH APPROPRIATE CUTTING BLADE. IF NEEDED, CLEAN UP EDGE WITH DEBURRING TOOL, BLADE, AND/OR METAL FILE.

11. WIPE THE SWEEP SURFACE CLEAN TO ENSURE STRONG BONDING OF TAPE. IF THE SWEEP HAS BECOME EXCESSIVELY DIRTY OR OILY, USE ISOPROPYL ALCOHOL TO CLEAN.

12. PEEL BACKING FROM PRE-APPLIED ADHESIVE SQUARES.

13. TO PREVENT ACCIDENTAL ADHESION, CAREFULLY SLIDE VERSA-LINE COVER DOWN ONTO SWEEP WHILE HOLDING THE BOTTOM OF THE COVER AWAY FROM SWEEP (C1). CLEAT ON THE COVER WILL ENGAGE CLEAT ON THE SWEEP. AFTER COVER BOTTOMS-OUT, CHECK SIDE-TO-SIDE ALIGNMENT, SLIDING AS NEEDED. ONCE ALIGNED, PRESS COVER TIGHTLY AGAINST THE SWEEP, FOCUSING ON THE AREAS NEAR THE TAPE (C2). **NOTE: ONCE FULLY ADHERED IT WILL BE VERY DIFFICULT TO REMOVE THE COVER SO ATTACH WITH CARE.**

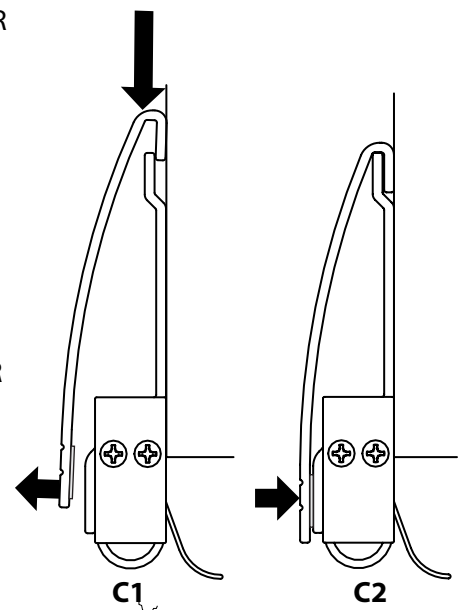

U.S. PATENT NO. 9,867,367